

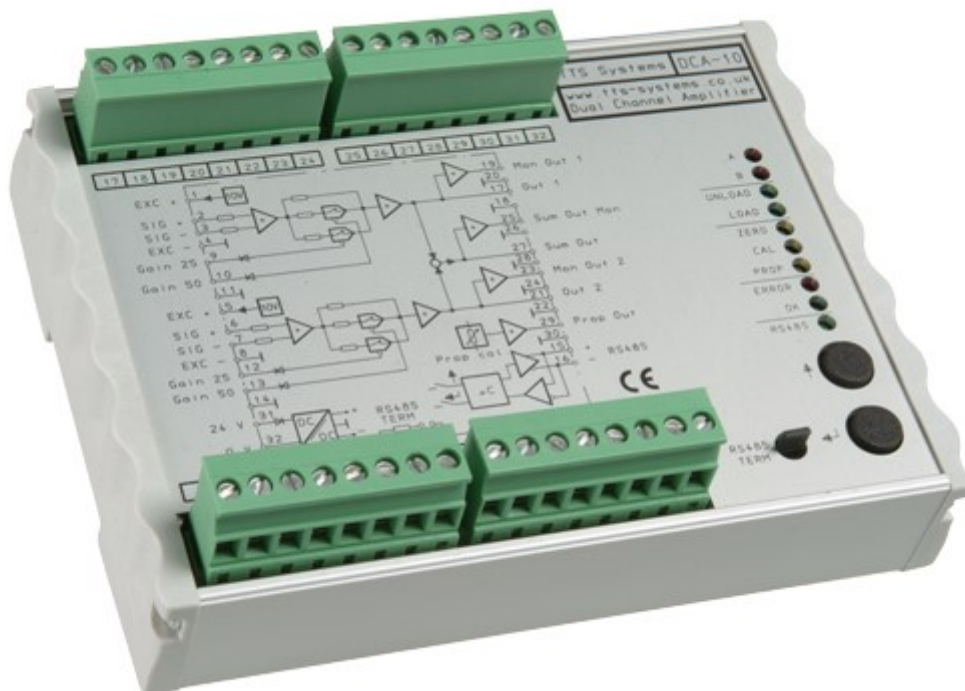

## DCA-10 Graphical Calibration Procedure

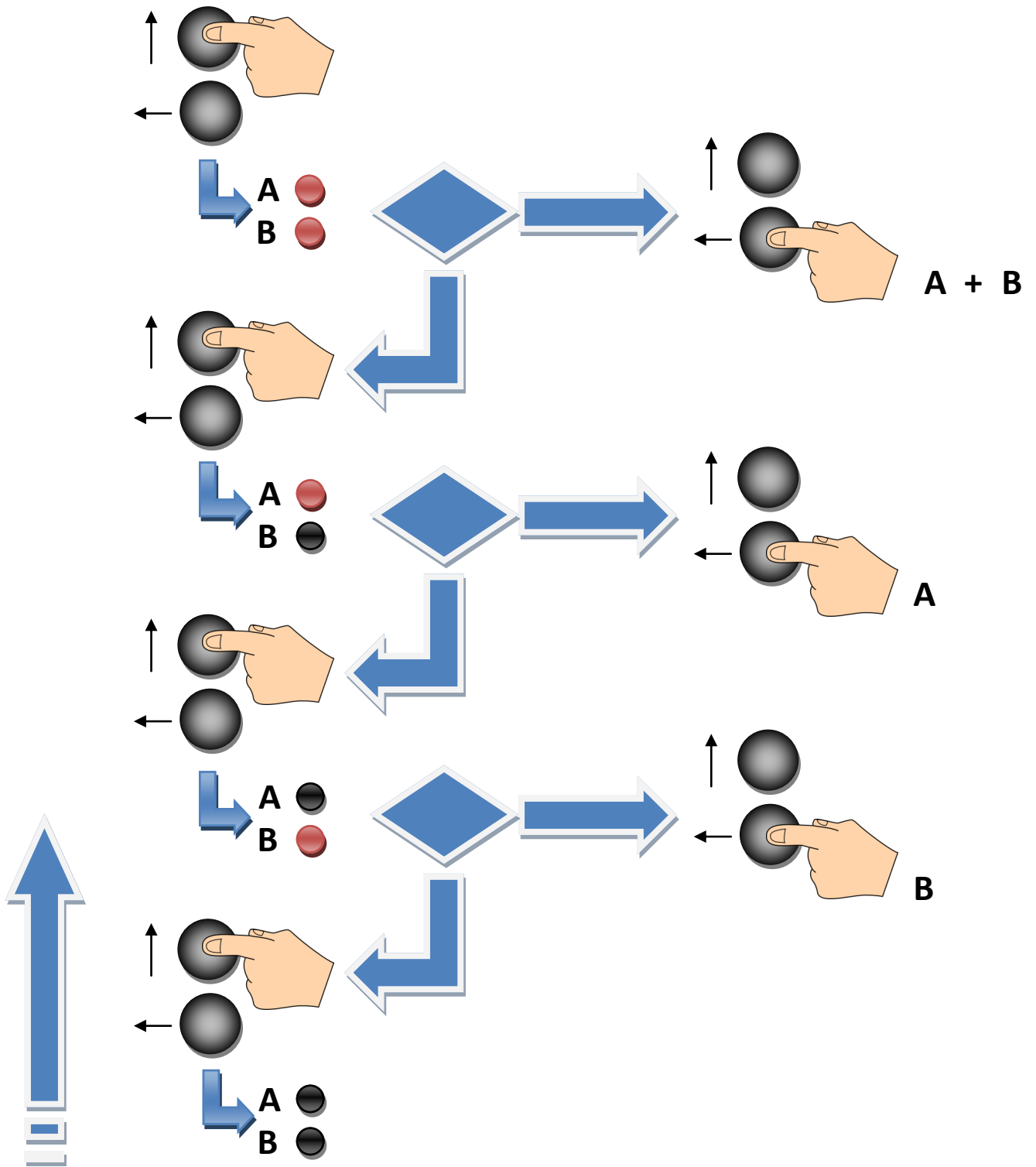

# 1—Select Channel



## 2—Select Function

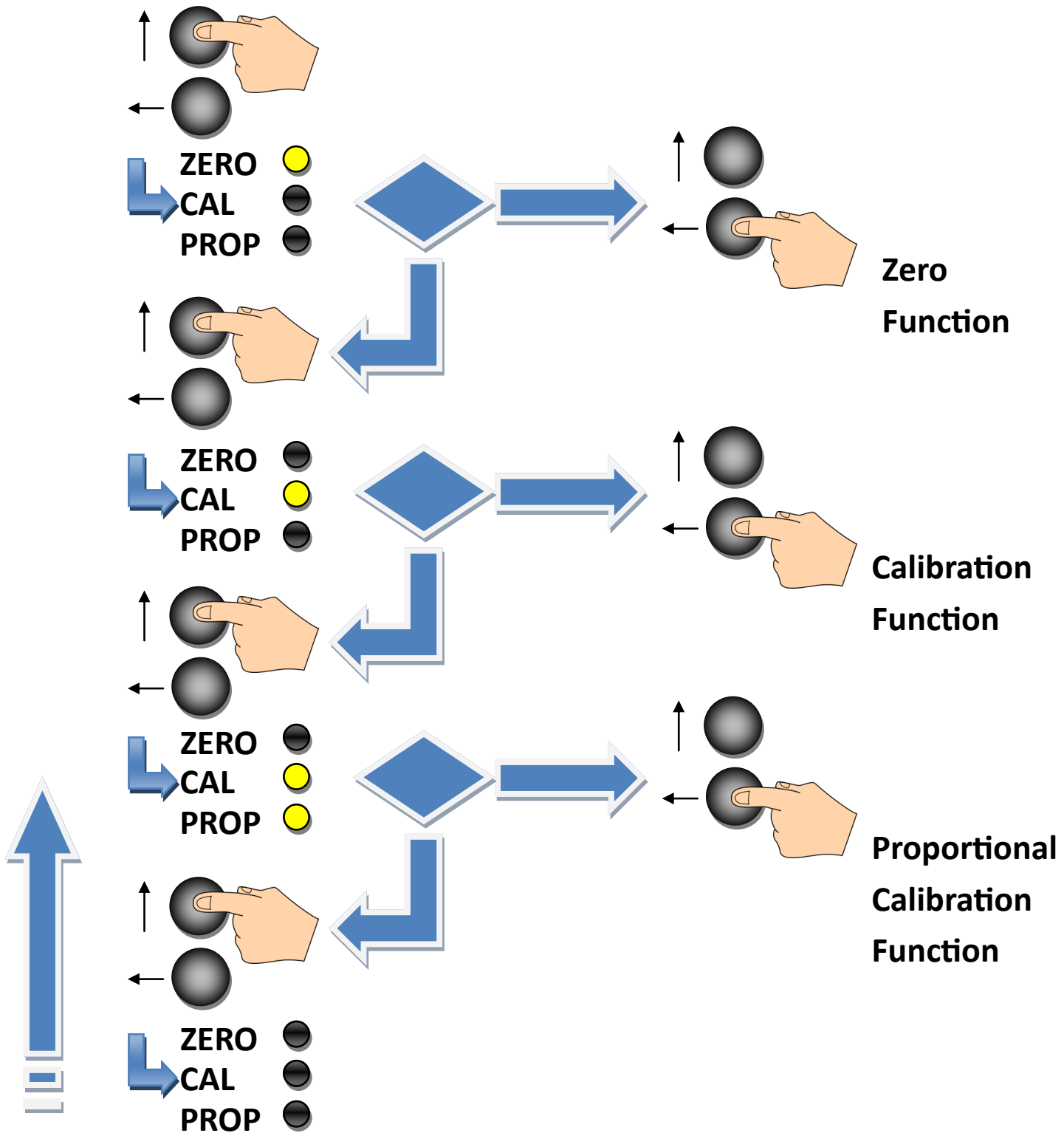

**1—Select Channel** → **2—Select Function** → **3—ZERO**

A ● A ● A ●  
 B ● B ● B ●

ZERO ●  
 CAL ●  
 PROP ●

**Zero Function**

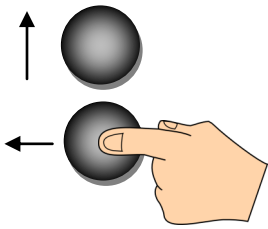

Unload ●  
 Load ●

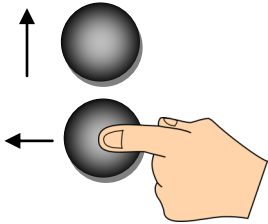
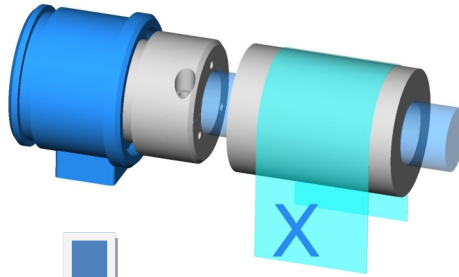

Unload ●  
 Load ●



ERROR ●  
 OK ●

OR

ERROR ●  
 OK ●

**1—Select Channel** → **2—Select Function** → **3—CAL**

A ● A ● A ●  
B ● B ● B ●

ZERO ●  
CAL ●  
PROP ●

**Calibration Function**

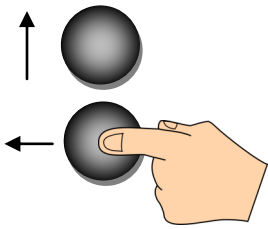

Unload ●  
Load ●

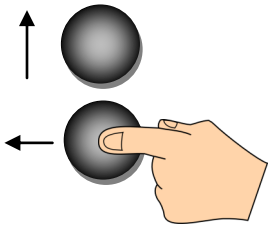
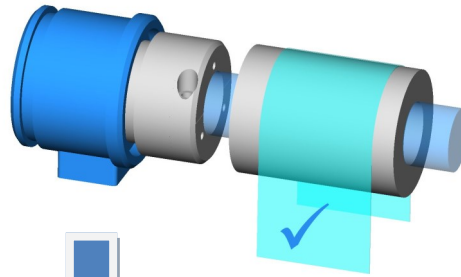

Unload ●  
Load ●



ERROR ●  
OK ●

OR

ERROR ●  
OK ●

**1—Select Channel** → **2—Select Function** → **3—PROP**

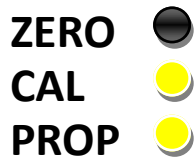
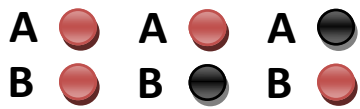

**Proportional Calibration Function**

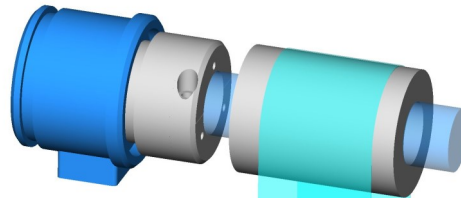
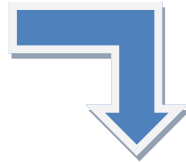
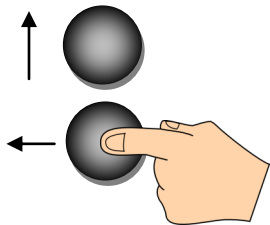

✓ X/Y

